

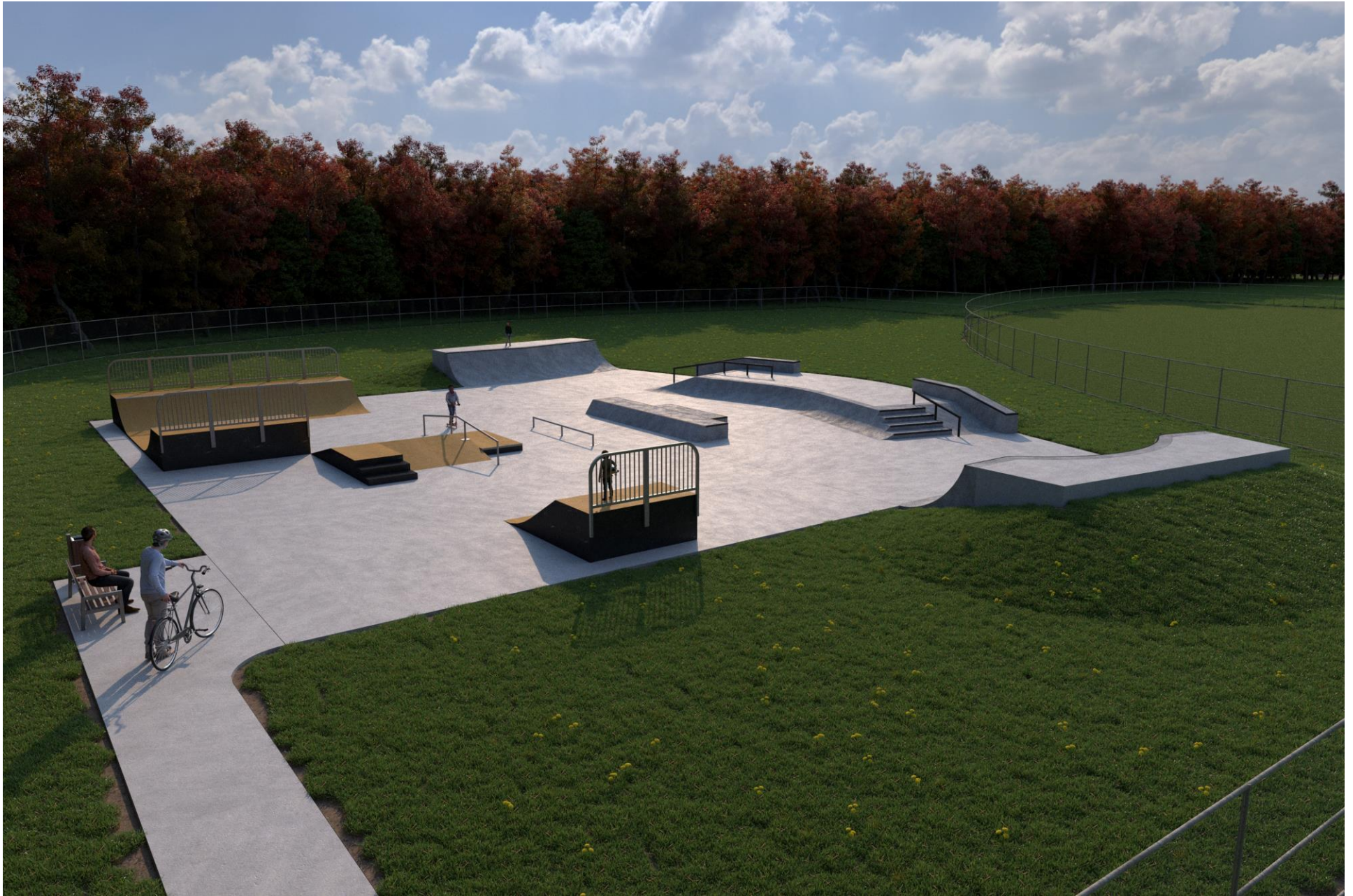

This page is the creative property of American Ramp Company. It cannot be copied or redistributed.



This page is the creative property of American Ramp Company. It cannot be copied or redistributed.



This page is the creative property of American Ramp Company. It cannot be copied or redistributed.



601 McKinley
 Joplin, MO 64801
 Tel: (417) 206-6816
 Toll Free: (800) 949-2024
 Fax: (417) 206-6888
sales@americanrampcompany.com

DRAWN BY J.D. Fields

DATE 3/14/23

REP. AGENCY

American Ramp Company

REP. NAME

Alec Belden

REP. PHONE

(800) 949-2024



CUSTOMER APPROVAL

DATE

PROJECT NAME

Rhinebeck Skatepark

DESIGN NO.

8075

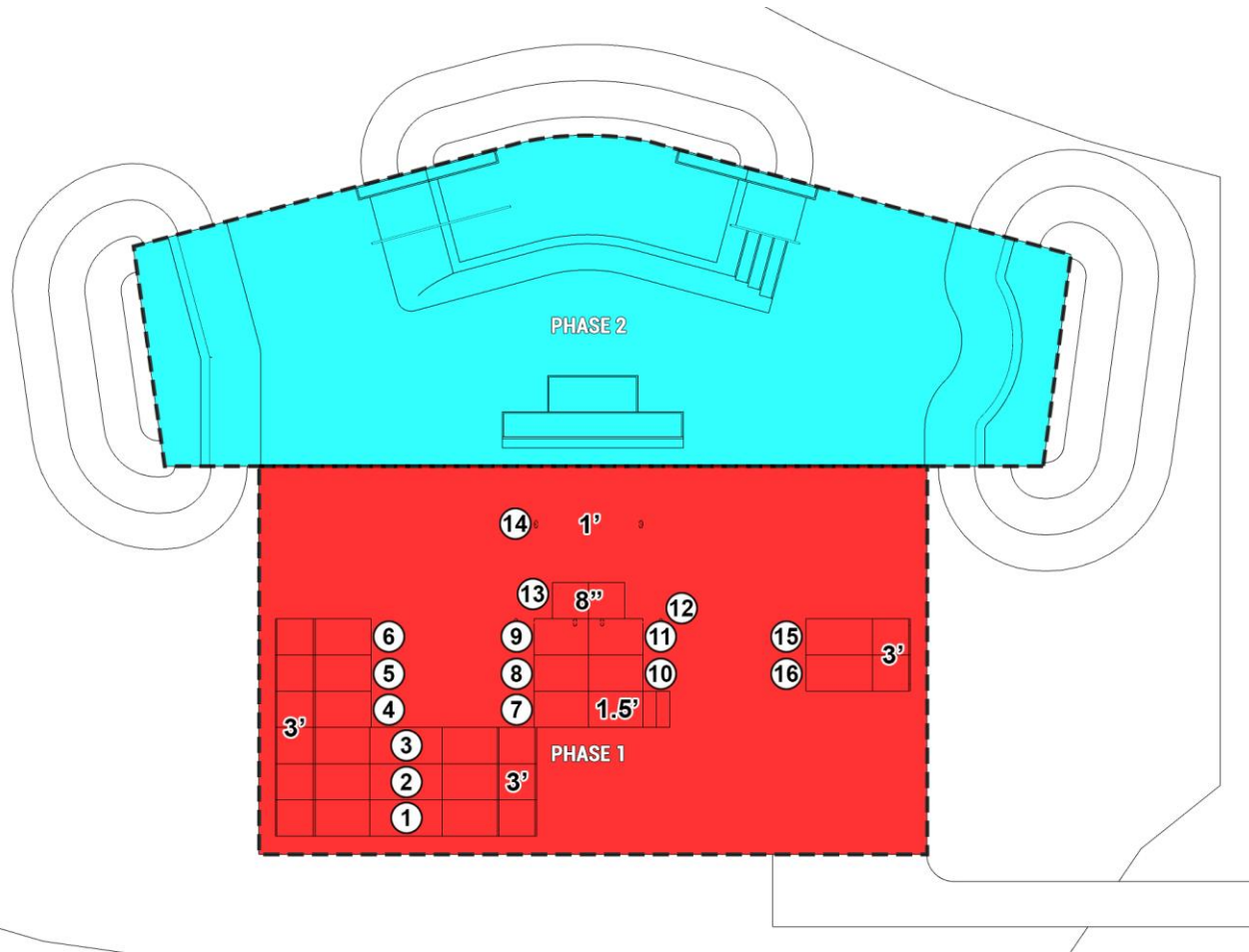

601 McKinley
 Joplin, MO 64801
 Toll-free 877-RAMP-778
 Local 417-206-6816
 Fax 417-206-6888
sales@americanrampcompany.com



Quote #	Design #	FOB	Date
Q27456.0	8075	Rhinebeck, NY	2/14/23

Phase 1

<u>Item</u>	<u>Obstacle</u>	<u>Height</u>	<u>Width</u>	<u>Length</u>
1	Half Pipe	3.0'	4.0'	28.0'
2	Half Pipe	3.0'	4.0'	28.0'
3	Half Pipe	3.0'	4.0'	28.0'
4	Quarter Pipe	3.0'	4.0'	10.0'
5	Quarter Pipe	3.0'	4.0'	10.0'
6	Quarter Pipe	3.0'	4.0'	10.0'
7	Wedge, Flat, Stair	1.5'	4.0'	15.0'
8	Bank Ramp (Wedge)	1.5'	4.0'	6.0'
9	Bank Ramp (Wedge)	1.5'	4.0'	6.0'
10	Bank Ramp (Wedge)	1.5'	4.0'	6.0'
11	Bank Ramp (Wedge)	1.5'	4.0'	6.0'
12	Grind Rail, Kinked (Round)	1.5'	2"	16.0'
13	Grindbox	8"	4.0'	8.0'
14	Grind Rail (Round)	1.0'	2"	12.0'
15	Bank Ramp	3.0'	4.0'	11.0'
16	Bank Ramp	3.0'	4.0'	11.0'

Subtotal	\$50,336.83
Framework Enclosures	\$5,033.68
Shipping/Handling	\$5,537.05
Installation	\$18,876.31
Concrete Pad	\$50,000.00
TOTAL	\$129,783.87
Estimated Monthly Payment, 5 Year Term	\$5,217.13

Notes:

- This turnkey quote includes Equipment, Shipping, and Installation.
- This quote includes prevailing wage.
- This quote does not include sales tax. If applicable, call for revised quote.
- Quote is good for 30 days.

Phase 2

Engineer's Estimate: \$225,000.00

Engineer's Estimate is based on the following assumptions:

Site/Foundation:

- A. Grade area to 6" depth, grubbing, remove dirt, required fill.
- B. Native soil subgrade compacted to 95% standard proctor.
- C. Minimum of 4" thick aggregate base course compacted to 95% standard proctor.
- D. Structural Fill or EPS Foam (Geofoam) for lifts.

Reinforced Concrete Flatwork:

- A. 4" concrete slab
 - a. Min 4000 PSI compressive strength at 28 days.
 - b. #4 steel rebar at 16" O.C. grid unless otherwise specified or determined by geo-technical report.
 - c. All rebar shall be cold bent.
 - d. Air entrainment percentage of 4%-6% unless adjusted because of aggregate size or exposure as per ACI 301 and ASTM C 260.
 - e. 6"x12" perimeter downturn.
 - f. All exposed outside concrete corners shall receive a 3/4" chamfer or 1/2" tooled radius.
 - g. Concrete finish will be smooth resulting from 2-3 passes with power trowel.
 - h. Saw Cut Joints will be cut at approx. 8'-12' grid spacing day after pour.
 - i. Cold Joints to have waterstop placed prior to final pour of adjacent slab.
 - j. If no geo-technical report is provided, Pivot Custom assumes existing sub-grade has sufficient bearing capacity. If unsuitable soil is found additional costs for over excavation and import fill may apply.
- B. 6" concrete slab
 - a. Min 4000 PSI compressive strength at 28 days.
 - b. #4 steel rebar at 16" O.C. grid unless otherwise specified or determined by geo-technical report.
 - c. All rebar shall be cold bent
 - d. Air entrainment percentage of 4%-6% unless adjusted because of aggregate size or exposure as per ACI 301 and ASTM C 260.
 - e. All exposed outside concrete corners shall receive a 3/4" chamfer or 1/2" tooled radius.
 - f. Concrete finish will be smooth resulting from 2-3 passes with power trowel.
 - g. Saw Cut Joints will be at approx. 8'-12' grid spacing day after pour.
 - h. Cold Joints to have waterstop placed prior to final pour of adjacent slab.
 - i. If no geo-technical report is provided, Pivot Custom assumes existing sub-grade has sufficient bearing capacity. If unsuitable soil is found additional costs for over excavation and import fill may apply.

Reinforced Sculptural Shotcrete:

- A. 6" concrete
 - a. Min 4000 PSI compressive strength.
 - b. #3 rebar steel reinforcing at 12" O.C. grid unless otherwise specified or determined by geo-technical report.
 - c. All rebar shall be cold bent
 - d. Air entrainment percentage of 4%-6% unless adjusted because of aggregate size or exposure as per ACI 301 and ASTM C 260.
 - e. All exposed outside concrete corners shall receive a 1/2" chamfer or 1/2" tooled radius.
 - f. Shotcrete finish will be smooth resulting from hand trowel unless otherwise noted.
 - g. Sawcuts will be cut at approx. 8'-12' spacing day after pour.
 - h. Cold Joints

Engineer's Estimate is based on the following assumptions:

Site/Foundation:

- A. Grade area to 6" depth, grubbing, remove dirt, required fill.
- B. Native soil subgrade compacted to 95% standard proctor.
- C. Minimum of 4" thick aggregate base course compacted to 95% standard proctor.
- D. Structural Fill or EPS Foam (Geofoam) for lifts.

Reinforced Concrete Flatwork:

- A. 4" concrete slab
 - a. Min 4000 PSI compressive strength at 28 days.
 - b. #4 steel rebar at 16" O.C. grid unless otherwise specified or determined by geo-technical report.
 - c. All rebar shall be cold bent.
 - d. Air entrainment percentage of 4%-6% unless adjusted because of aggregate size or exposure as per ACI 301 and ASTM C 260.
 - e. 6"x12" perimeter downturn.
 - f. All exposed outside concrete corners shall receive a 3/4" chamfer or 1/2" tooled radius.
 - g. Concrete finish will be smooth resulting from 2-3 passes with power trowel.
 - h. Saw Cut Joints will be cut at approx. 8'-12' grid spacing day after pour.
 - i. Cold Joints to have waterstop placed prior to final pour of adjacent slab.
 - j. If no geo-technical report is provided, Pivot Custom assumes existing sub-grade has sufficient bearing capacity. If unsuitable soil is found additional costs for over excavation and import fill may apply.
- B. 6" concrete slab
 - a. Min 4000 PSI compressive strength at 28 days.
 - b. #4 steel rebar at 16" O.C. grid unless otherwise specified or determined by geo-technical report.
 - c. All rebar shall be cold bent
 - d. Air entrainment percentage of 4%-6% unless adjusted because of aggregate size or exposure as per ACI 301 and ASTM C 260.
 - e. All exposed outside concrete corners shall receive a 3/4" chamfer or 1/2" tooled radius.

This page is the creative property of American Ramp Company. It cannot be copied or redistributed.

- f. Concrete finish will be smooth resulting from 2-3 passes with power trowel.
- g. Saw Cut Joints will be at approx. 8'-12' grid spacing day after pour.
- h. Cold Joints to have waterstop placed prior to final pour of adjacent slab.
- i. If no geo-technical report is provided, Pivot Custom assumes existing sub-grade has sufficient bearing capacity. If unsuitable soil is found additional costs for over excavation and import fill may apply.

Reinforced Sculptural Shotcrete:

- A. 6" concrete
 - a. Min 4000 PSI compressive strength.
 - b. #3 rebar steel reinforcing at 12" O.C. grid unless otherwise specified or determined by geo-technical report.
 - c. All rebar shall be cold bent
 - d. Air entrainment percentage of 4%-6% unless adjusted because of aggregate size or exposure as per ACI 301 and ASTM C 260.
 - e. All exposed outside concrete corners shall receive a 1/2" chamfer or 1/2" tooled radius.
 - f. Shotcrete finish will be smooth resulting from hand trowel unless otherwise noted.
 - g. Sawcuts will be cut at approx. 8'-12' spacing day after pour.
 - h. Cold Joints

Purchase through our competitively bid government Sourcewell contract.

